



### **3 Milton Close, Castlefields, Shrewsbury SY1 2UE**

2 bedroom semi-detached bungalow—£265,000 Freehold



## 3 Milton Close, Castlefields, Shrewsbury SY1 2UE

Coopergreenpooks.co.uk

£265,000 Freehold—2 bedroom semi-detached house

sales@cgpooks.co.uk

Occupying a fantastic position, tucked away within a quiet cul-de-sac, just a short walk from the banks of the River Sever, this neatly presented and well-maintained semi-detached bungalow offers very practical and extended accommodation, while benefitting from a private garden, driveway parking and detached garage.

### KEY FEATURES

- Entrance porch opening to a good-sized inner hallway
- Large living/dining room with a feature fireplace and bay window to front
- Separate kitchen with a range of fitted units, useful storage, and access to the extended garden room
- Two bedrooms, both having built in wardrobes, with the master having a bay window to front
- Modern family shower room with corner shower and vanity unit
- Lovely private rear garden, extending to the side of the property, partially laid to lawn with paved sun terrace, timber stores, greenhouse, and gated access to the front
- Driveway parking for at least two cars, as well as a large detached single garage with additional space behind
- A superb location within a quiet and popular residential area, a stone's throw from the river Severn via a footpath providing access to beautiful riverside walks. The train station is also just a short walk away, as is the heart of the town centre
- Sold with no upward chain

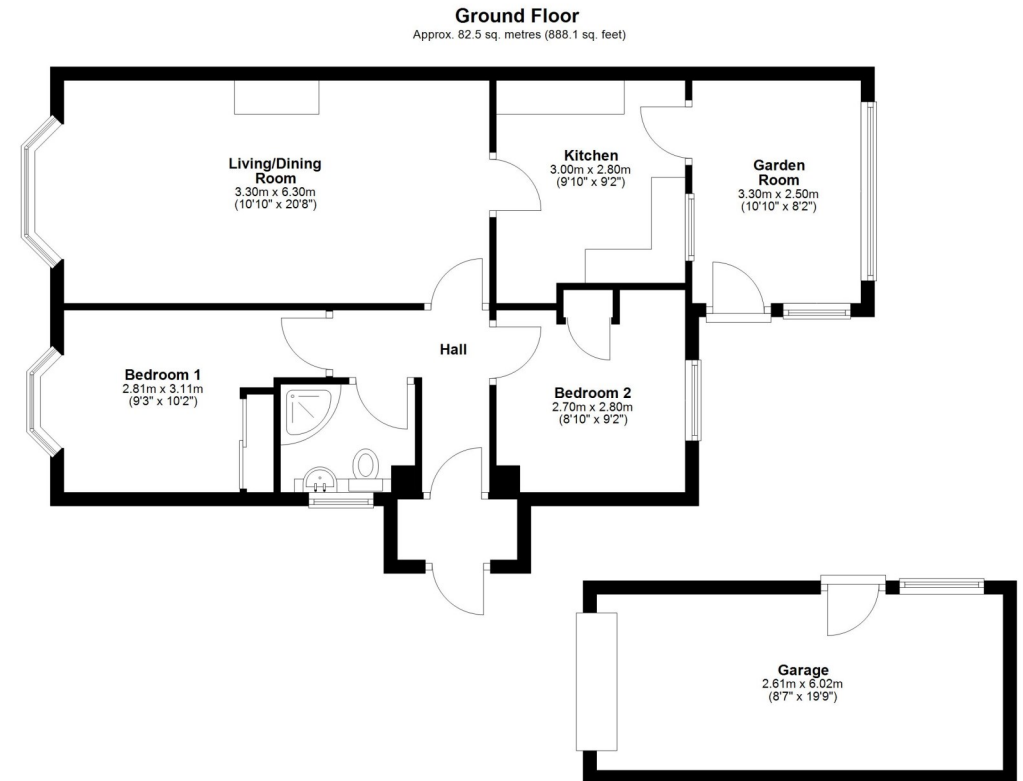

Total area: approx. 82.5 sq. metres (888.1 sq. feet)















## 3 Milton Close, Castlefields, Shrewsbury SY1 2UE

£265,000 Freehold—2 bedroom semi-detached house

sales@cgpooks.co.uk

rightmove

onTheMarket.com

RICS  
Regulated by RICS



**BOUNDARIES NOT CONFIRMED**

Tenure	<b>Freehold</b>
Local Authority	<b>Shropshire Council</b>
Council Tax	<b>Band B</b>
EPC Band	<b>TBC</b>
Services	<b>All mains services are connected</b>

**Expert mortgage advice available**

3 Barker St, Shrewsbury SY1 1QF

**Cooper Green Pooks**  
**01743 276666**



Your home may be repossessed if you do not keep up repayments on your mortgage.

There may be a fee for mortgage advice. The actual amount you pay will depend upon your circumstances. The fee is up to 1% but a typical fee is 0.3% of the amount borrowed.



### 3 Milton Close, Castlefields, Shrewsbury SY1 2UE

Coopergreenpooks.co.uk

£265,000 Freehold—2 bedroom semi-detached house

sales@cgpooks.co.uk

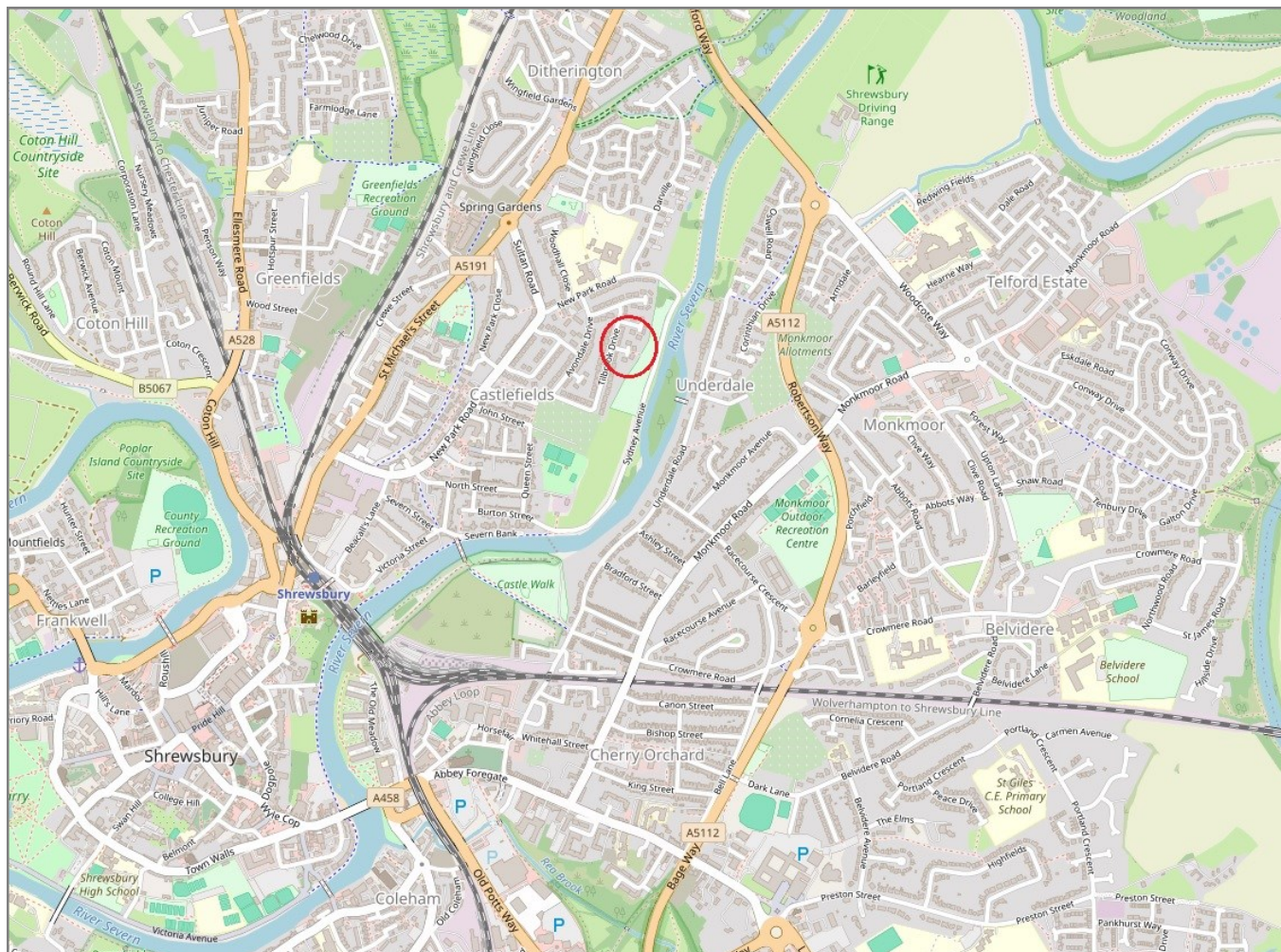

**IMPORTANT NOTICE:** Cooper Green Pooks for themselves and for the lessors or vendors of this property whose agents they are give notice that: 1 No appliances, services or service installations have been tested and no warranty as to suitability or serviceability is implied. Any prospective purchaser or lessee is advised to obtain verification from their surveyor or solicitor. 2. The particulars are set out as a general outline only for the guidance of the intended purchasers or lessees and do not constitute, nor constitute part of, an offer or contract. 3. All descriptions, reference to condition and necessary permissions for use and occupation and other details are given in good faith and are believed to be correct but any intending purchasers or lessees should not rely on them as statements or representation of fact but satisfy themselves by inspection or otherwise as to the correctness of each of them. 4. No person in the employment of Cooper Green Pooks has any authority to make or give any representation or warranty whatsoever in relation to this property. 5. All rentals and prices are quoted exclusive of Stamp Duty, legal and surveyors fees and any other associated purchasers or lessees costs. 6. Floor plans are indicative only and should not be relied on. 7. The plan showing the boundary of the property is indicative only and has not been checked against the legal title so should not be relied on. 8. All dimensions, floor areas and site areas are only approximate and should not be relied on. Dimensions are generally maximum room dimension.